

# Dual Pack RCM&E Info Sheet

Rudder Pushrod

Elevator Pushrod

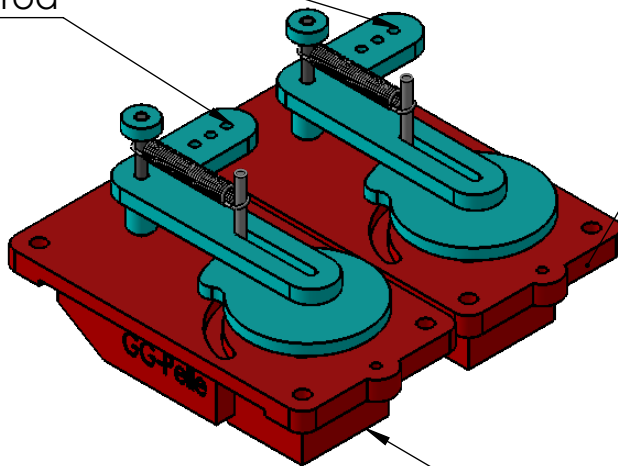

Rudder connector from Recoder connects to AIL on RX, this connector should include also power from Rx

Rudder connector from Recoder connects to ELEV on RX, this connector should include also power from Rx

A "Dual Pack" set up for the Quickie Ghost requires 2 full set of actuators mechanically as electronic wise. The only difference is that the Elevator plates have been removed and the pushrod from Rudder & Elevator are both connected to the Rudder plates. Each actuator is separate like any modern servo set up thus, no interaction between inputs.

Concerning connection to the Rx the " Rudder" from the 2 Recoders are connected to AIL and ELEV, respectively. This will give a standard pulse rate but if a variable pulse rate is desired there is the option to connect the 2 Elevator Connectors from the Recoder in parallel to an AUX channel on the Rx allowing the control of it from the Tx. Remember that each Rudder connector from the Recoders must include also power from the Rx but the ELEV just need Signal